

Cat 5e

56Y4  
E145249



COMMUNICATION  
CIRCUIT ACCESSORIES



REARVIEW

**MATERIAL**

PANEL : SECC WITH ZINC UNDERCOAT, BLACK POWDER PAINTING FINISH  
 PLASTIC FRAME : ABS HIGH-IMPACT UL94V-0 THERMOPLASTIC  
 CONTACT HOLDER : ABS HIGH-IMPACT UL94V-0 THERMOPLASTIC  
 SPRING WIRE : PHOSPHOR BRONZE 5100W TEMPER WIRE, Φ=0.45MM,  
 3U" AU / 30U" PDNI OVER 60U" NICKEL UNDERCOATABS HIGH-IMPACT UL94V-0 THERMOPLASTIC  
 IDC PLASTIC : POLYCARBONATE RESIN HIGH-IMPACT UL94V-2  
 IDC CONTACT : PHOSPHOR BRONZE C5191R-H, T=0.4MM, 80U" NICKEL PLATED

**PHYSICAL CHARACTERISTICS**

INSERTION LIFE : 750 MATING CYCLES WITH FCC COMPLIANT RJ-45 PLUG  
 CONTACT FORCE : 100 GRAMS WITH FCC COMPLIANT RJ-45 PLUG  
 PLUG RETENTION FORCE : 11 LBF MIN.  
 DURABILITY : 200 TERMINATION CYCLES  
 CONTACT COMPATIBILITY : ACCOMMODATES 22 TO 26 AWG SOLID / 24 AWG STRANDED  
 OPERATING TEMPERATURE RANGE : -10°C TO 60°C  
 STORAGE TEMPERATURE RANGE : -40°C TO 68°C  
 HUMIDITY : 10%~90%RH

**ELECTRICAL**

INSULATION RESISTANCE : 500 MΩ  
 DIELECTRIC WITHSTANDING VOLTAGE : 1000 V  
 DC CURRENT RATING : 1.5 Amps  
 DC RESISTANCE : 0.1Ω  
 CONTACT RESISTANCE : 20mΩ

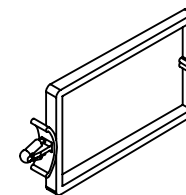

**ENCLOSURE**

NYLON CABLE TIE X 4 PCS  
 INSTRUCTION X 1 PC  
 CABLE MANAGER X 2PCS

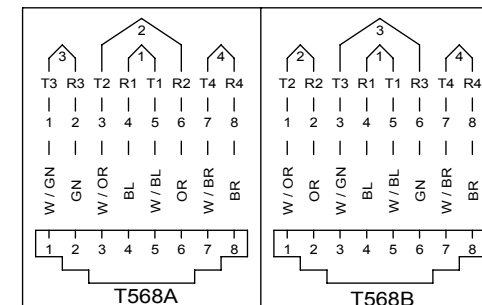

Scale		2:5		All Copy Rights Reserved	
3rd Angle Projection				DAN-CHIEF ENTERPRISE CO., LTD.	
Unit		mm		Title	
Date		2009/10/24		O3012IP9IAXBFE6APD001	
Tolerance					
~20	~50	~150	150~	ANGLE	
±0.2	±0.4	±0.5	±1.5	±2°	Drawn by Kata Lo
				Checked by	